



PINNACLE

*Vegas is so ready for this!*

 residence **A**

STUDIO

Interior: 588 Sq. Ft.  
Balcony: 67 Sq. Ft.  
Total Residence: 655 Sq. Ft.

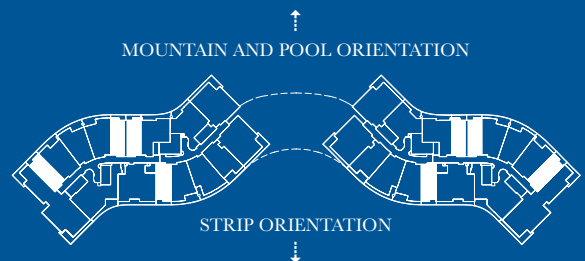
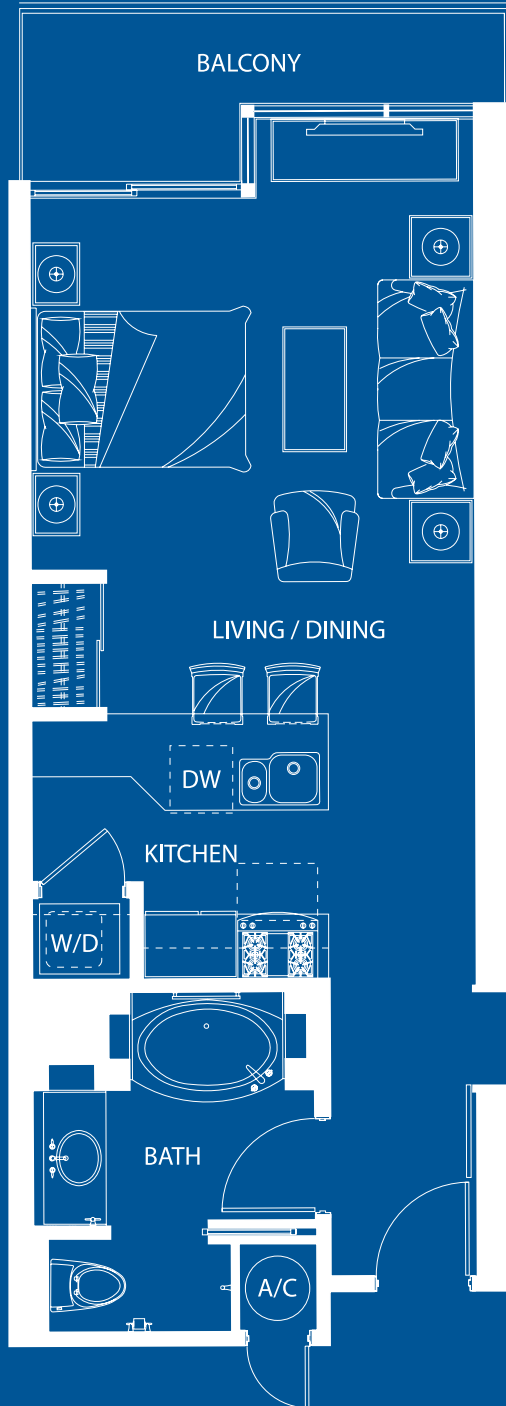

The floorplans are subject to change without notice. The seller reserves the absolute right, in its sole judgment and discretion, to substitute appliances, materials, fixtures and equipment of equal or greater quality or value for those specified. Units denoted on key plan as similar units may vary in size and dimensions from the plan featured above.



**PINNACLE**

*Vegas is so ready for this!*

 **residence B**

**1 BEDROOM / 1 BATH**

**Interior:** 788 - 878 Sq. Ft.  
**Balcony:** 136 - 169 Sq. Ft.  
**Total Residence:** 957 - 1,020 Sq. Ft.

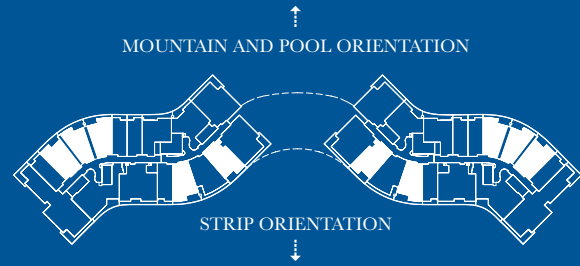
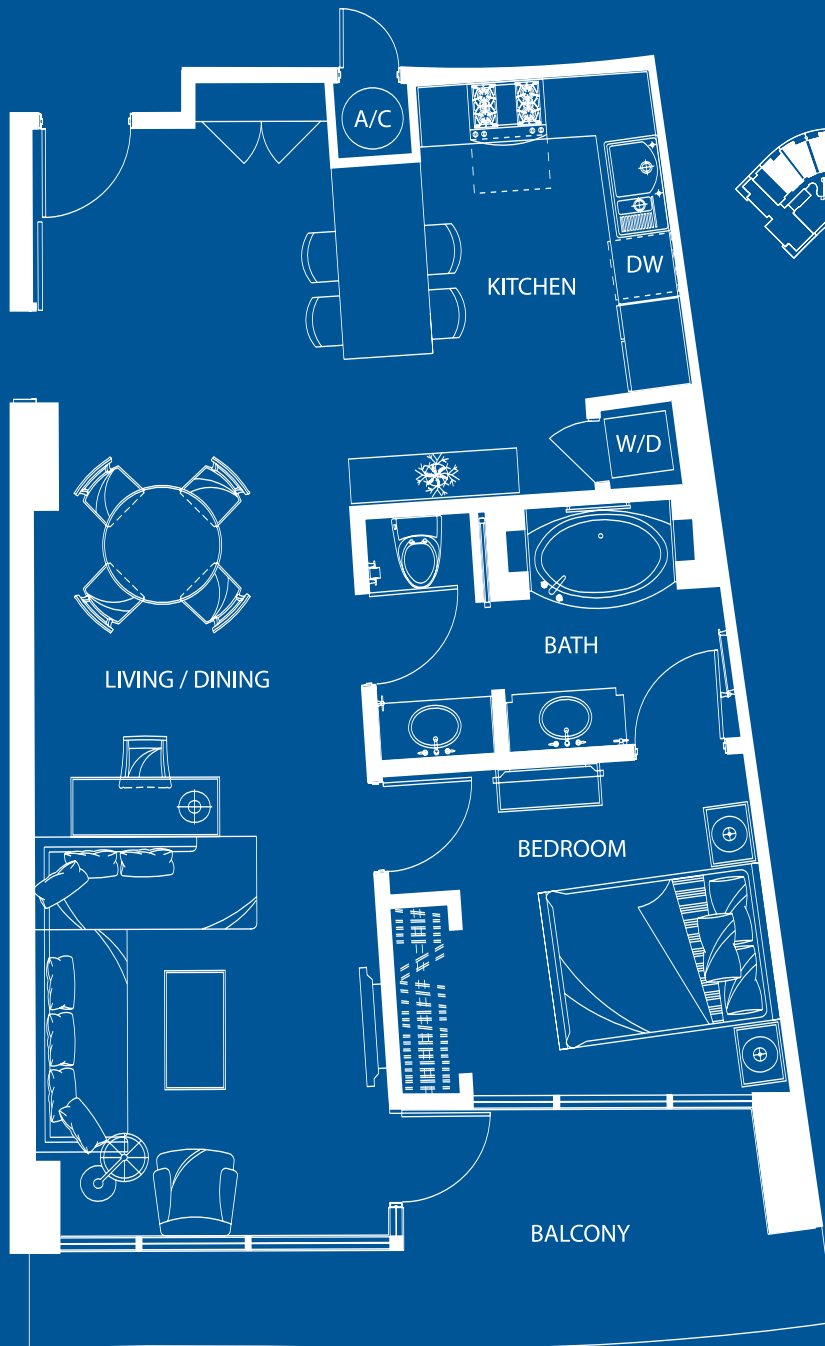

The floorplans are subject to change without notice. The seller reserves the absolute right, in its sole judgment and discretion, to substitute appliances, materials, fixtures and equipment of equal or greater quality or value for those specified. Units denoted on key plan as similar units may vary in size and dimensions from the plan featured above.



P I N N A C L E

*Vegas is so ready for this!*

1 BEDROOM / 1 1/2 BATH

residence C

Interior:	988 Sq. Ft.
Balcony:	124 - 185 Sq. Ft.
Total Residence:	1,112 - 1,173 Sq. Ft.

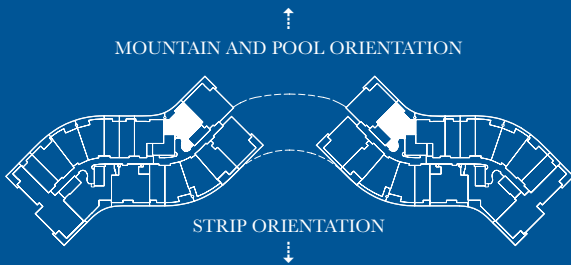
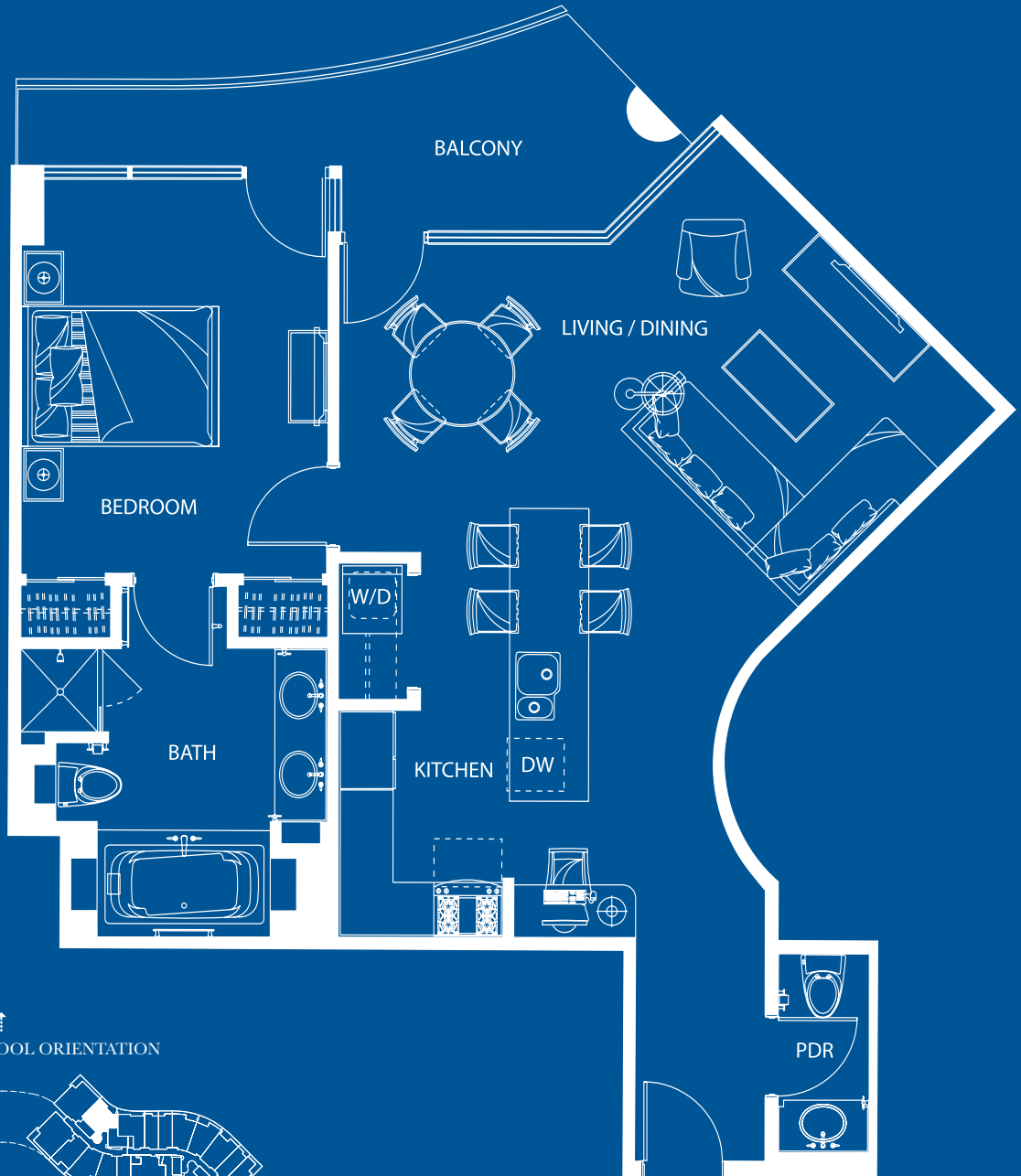

The floorplans are subject to change without notice. The seller reserves the absolute right, in its sole judgment and discretion, to substitute appliances, materials, fixtures and equipment of equal or greater quality or value for those specified. Units denoted on key plan as similar units may vary in size and dimensions from the plan featured above.



**PINNACLE**

*Vegas is so ready for this!*

 residence **D**

**1 BEDROOM / 1 BATH**

<b>Interior:</b>	<b>830 Sq. Ft.</b>
<b>Balcony:</b>	<b>161 - 238 Sq. Ft.</b>
<b>Total Residence:</b>	<b>991 - 1,068 Sq. Ft.</b>

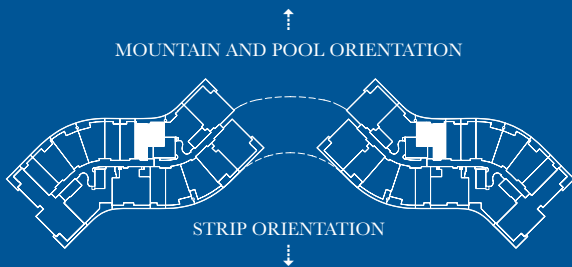
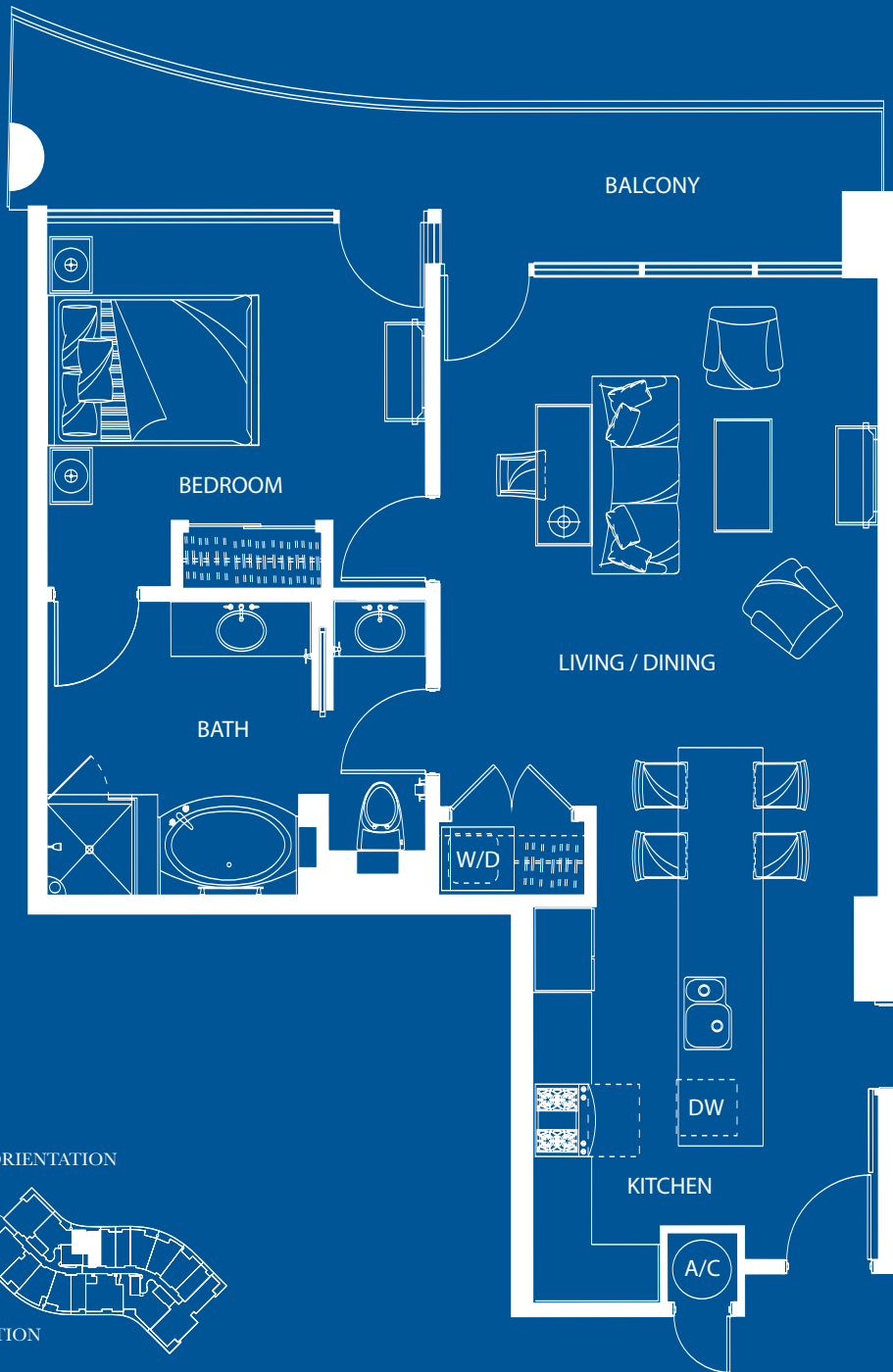

The floorplans are subject to change without notice. The seller reserves the absolute right, in its sole judgment and discretion, to substitute appliances, materials, fixtures and equipment of equal or greater quality or value for those specified. Units denoted on key plan as similar units may vary in size and dimensions from the plan featured above.



PINNACLE

*Vegas is so ready for this!*

 residence **E**

2 BEDROOM / 2 BATH

Interior:	1,250 - 1,256 Sq. Ft.
Balcony:	197 - 262 Sq. Ft.
Total Residence:	1,447 - 1,512 Sq. Ft.

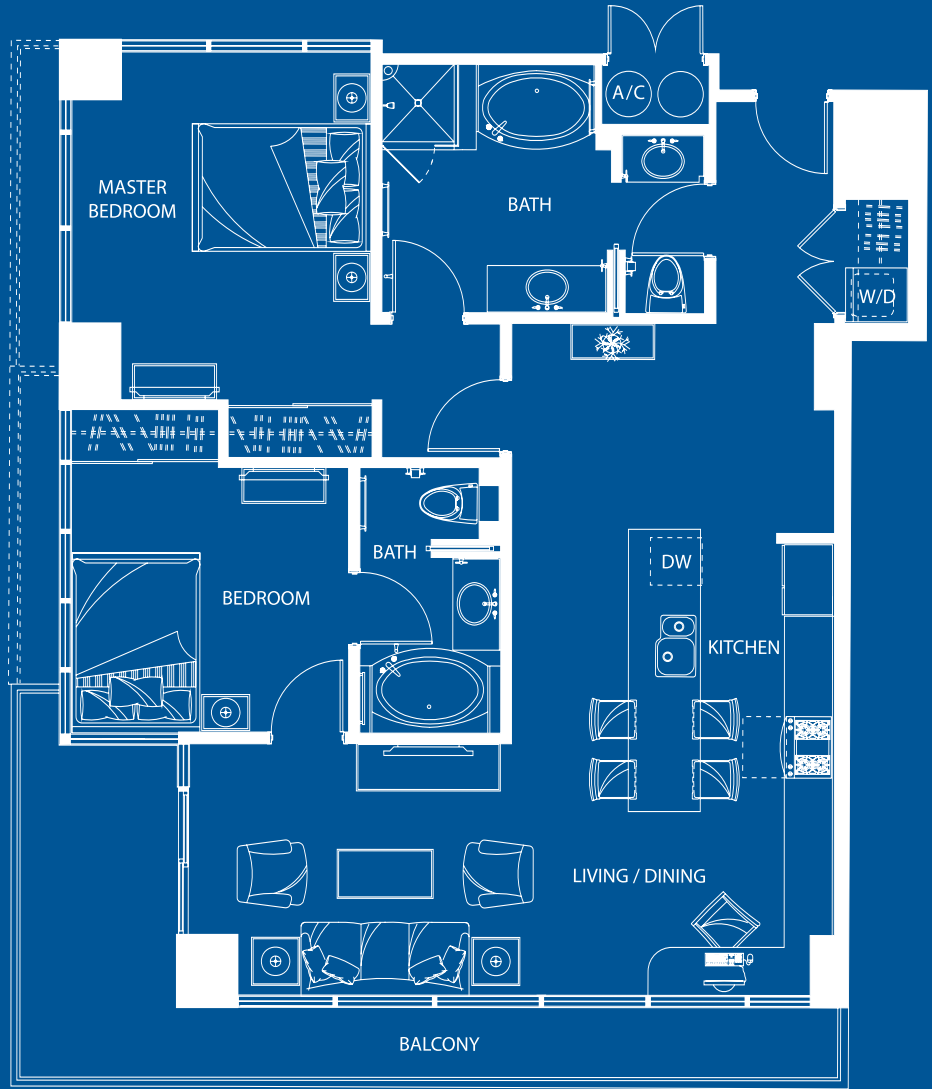

↑  
MOUNTAIN AND POOL ORIENTATION

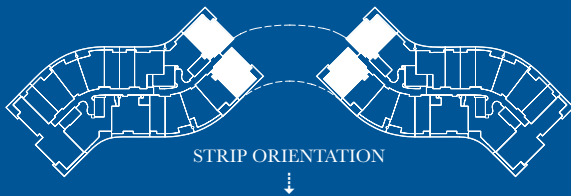

The floorplans are subject to change without notice. The seller reserves the absolute right, in its sole judgment and discretion, to substitute appliances, materials, fixtures and equipment of equal or greater quality or value for those specified. Units denoted on key plan as similar units may vary in size and dimensions from the plan featured above.



PINNACLE

*Vegas is so ready for this!*

2 BEDROOM / 1 BATH

 residence **F**

Interior: 932 Sq. Ft.  
Balcony: 163 Sq. Ft.  
Total Residence: 1,095 Sq. Ft.

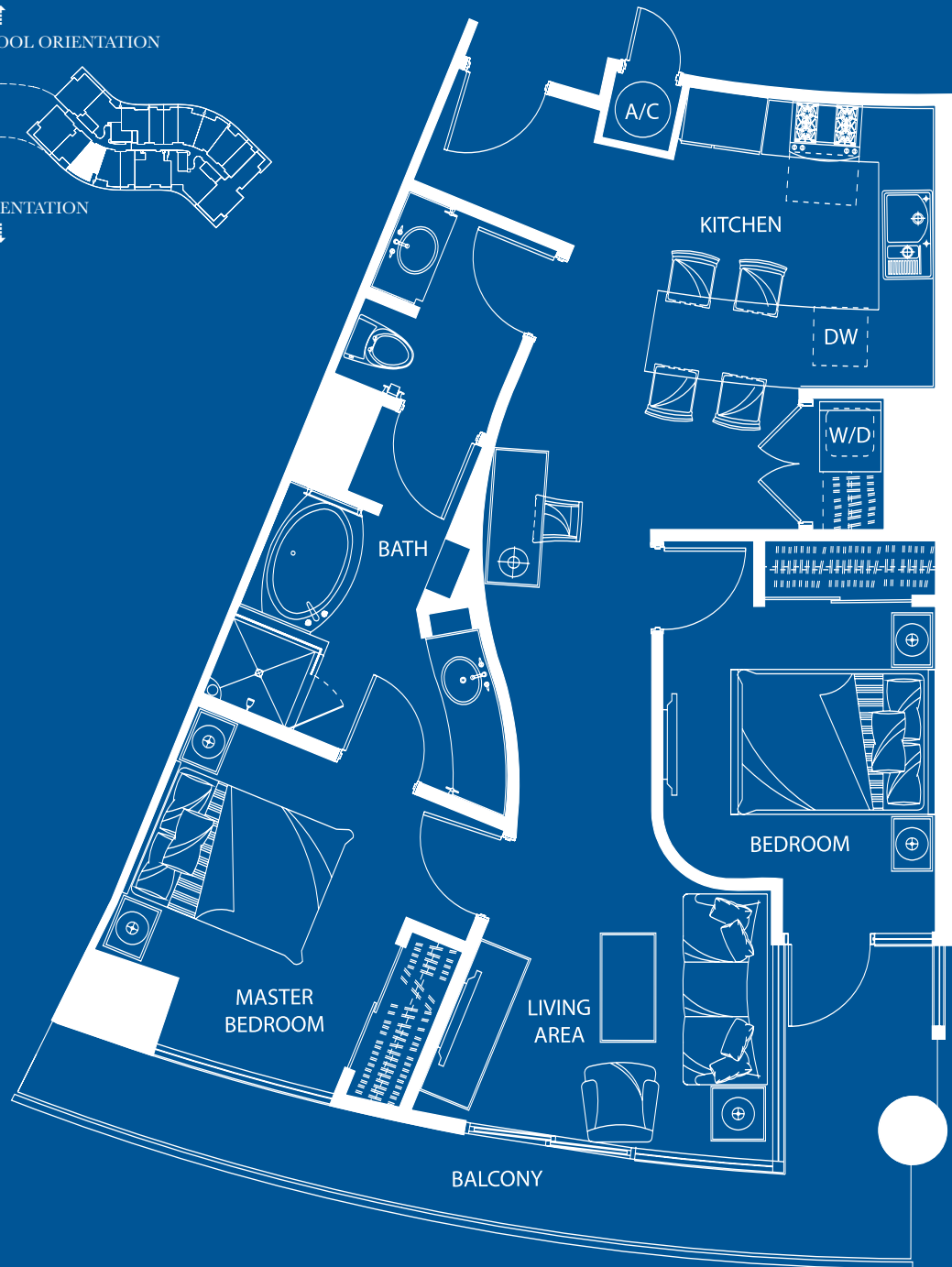
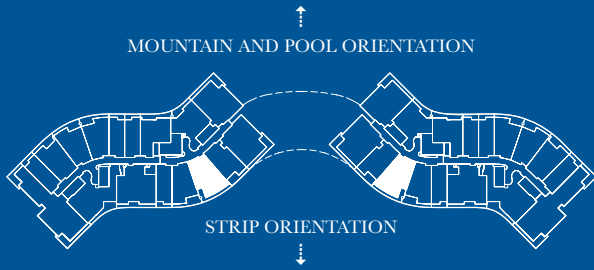

The floorplans are subject to change without notice. The seller reserves the absolute right, in its sole judgment and discretion, to substitute appliances, materials, fixtures and equipment of equal or greater quality or value for those specified. Units denoted on key plan as similar units may vary in size and dimensions from the plan featured above.



**PINNACLE**

*Vegas is so ready for this!*

**2 BEDROOM / 2 1/2 BATH**

**residence G**

<b>Interior:</b>	<b>1,204 Sq. Ft.</b>
<b>Balcony:</b>	<b>158 - 202 Sq. Ft.</b>
<b>Total Residence:</b>	<b>1,362 - 1,406 Sq. Ft.</b>

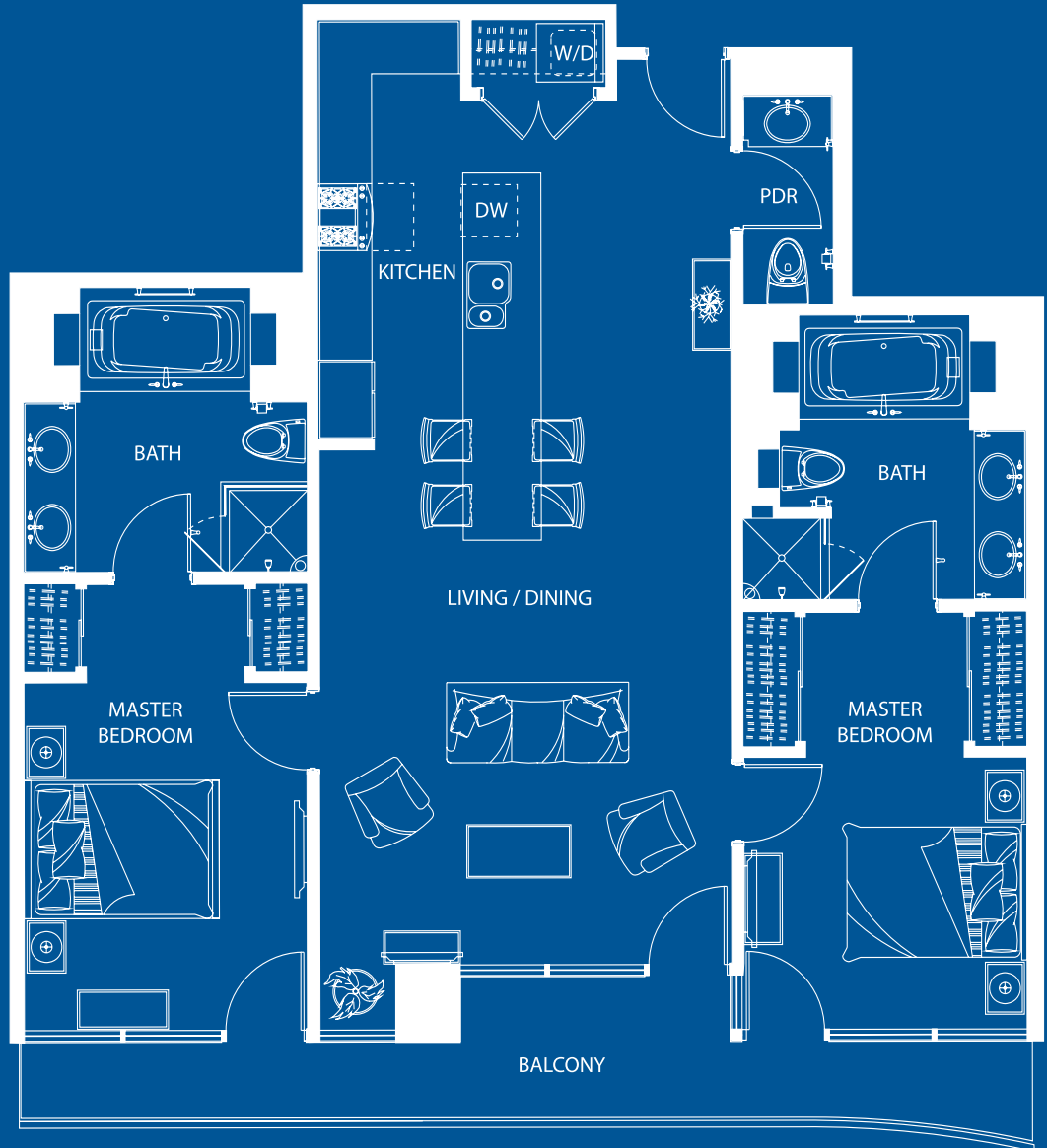

↑  
MOUNTAIN AND POOL ORIENTATION

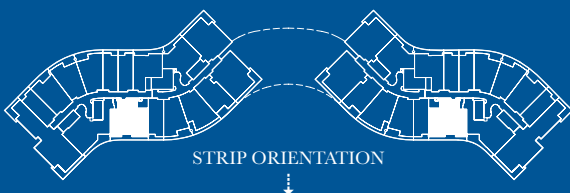

The floorplans are subject to change without notice. The seller reserves the absolute right, in its sole judgment and discretion, to substitute appliances, materials, fixtures and equipment of equal or greater quality or value for those specified. Units denoted on key plan as similar units may vary in size and dimensions from the plan featured above.



**P I N N A C L E**

*Vegas is so ready for this!*

**2 BEDROOM / 2 1/2 BATH**

**residence H**

<b>Interior:</b>	<b>1,289 Sq. Ft.</b>
<b>Balcony:</b>	<b>180 - 276 Sq. Ft.</b>
<b>Total Residence:</b>	<b>1,469 - 1,565 Sq. Ft.</b>

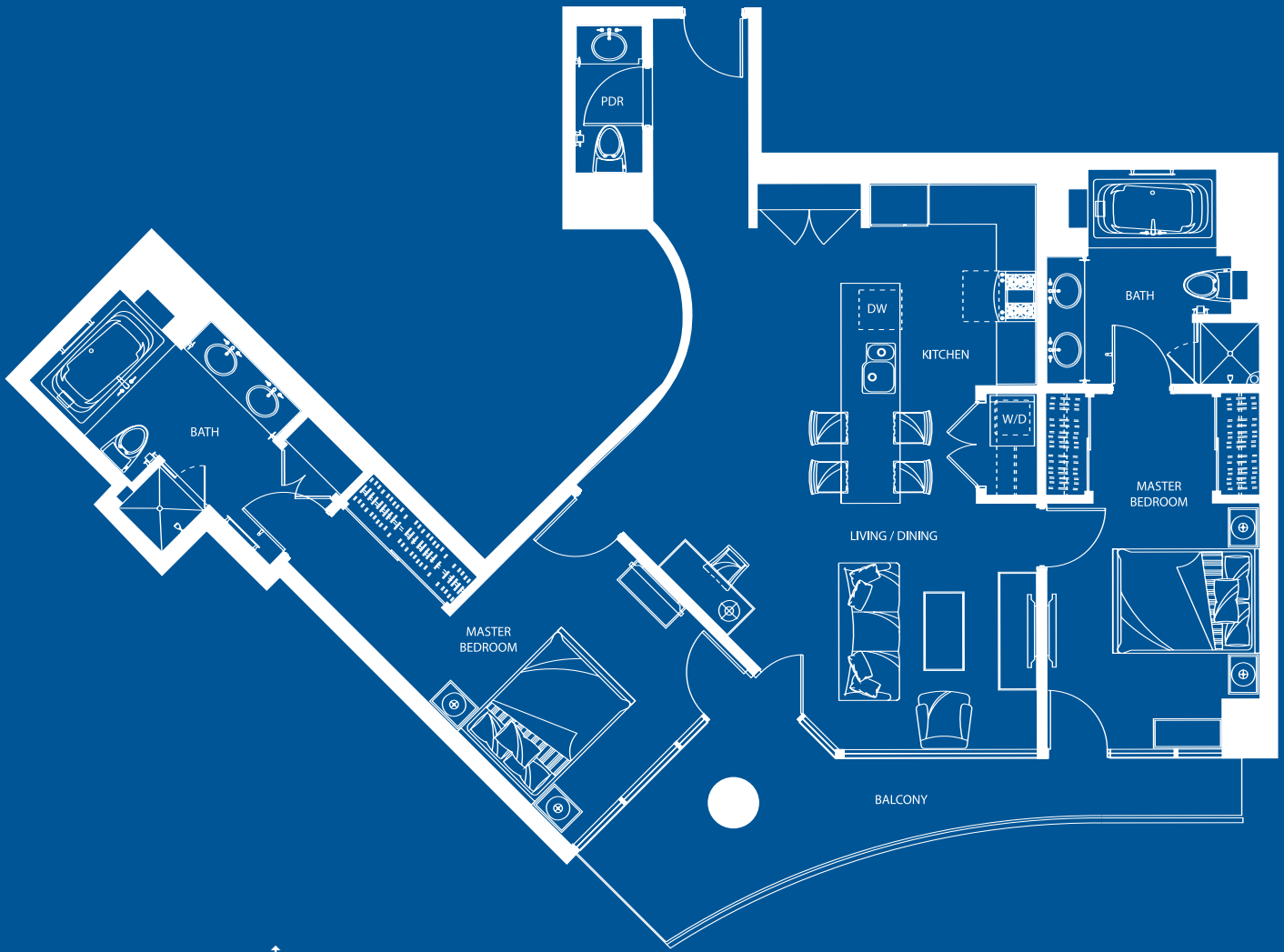

↑  
MOUNTAIN AND POOL ORIENTATION

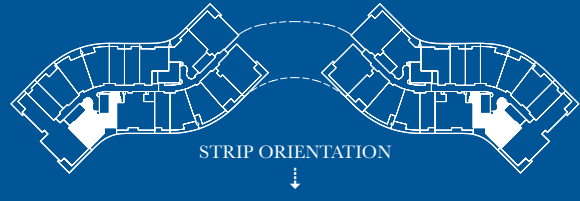

↓  
STRIP ORIENTATION

The floorplans are subject to change without notice. The seller reserves the absolute right, in its sole judgment and discretion, to substitute appliances, materials, fixtures and equipment of equal or greater quality or value for those specified. Units denoted on key plan as similar units may vary in size and dimensions from the plan featured above.





PINNACLE

*Vegas is so ready for this!*

3 BEDROOM / 2 1/2 BATH

 residence I

Interior: 1,884 Sq. Ft.  
Balcony: 372 - 419 Sq. Ft.  
Total Residence: 2,256 - 2,303 Sq. Ft.

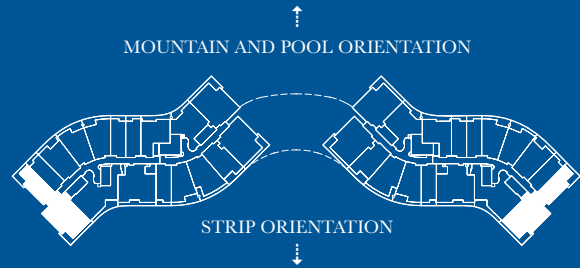
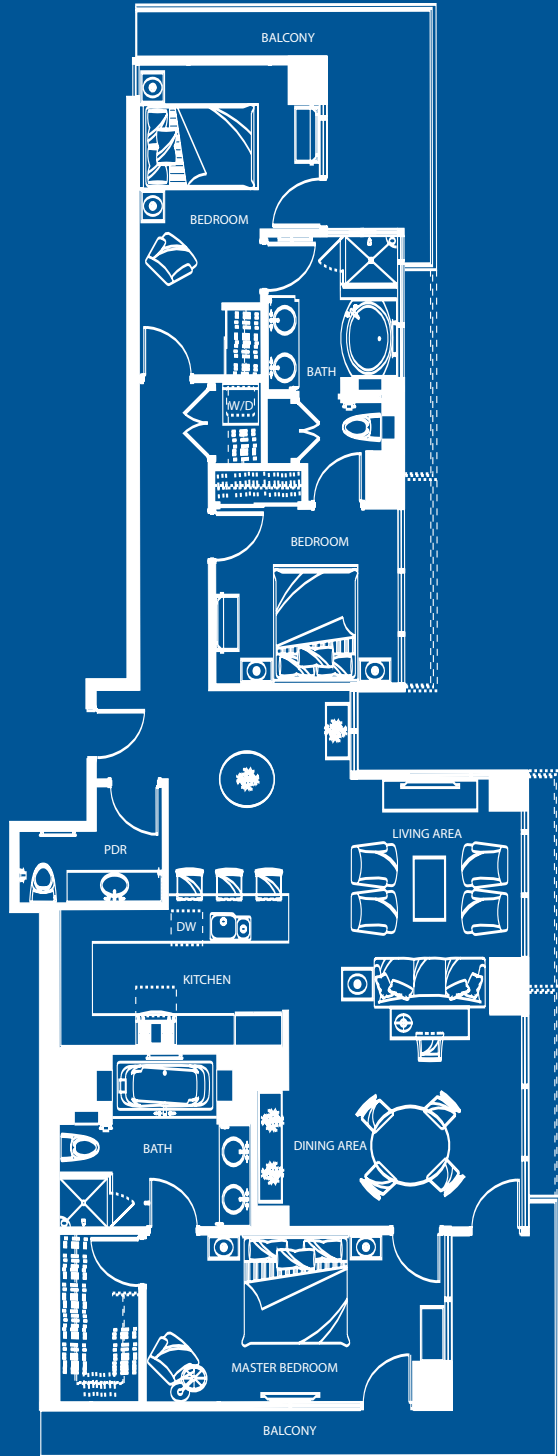

The floorplans are subject to change without notice. The seller reserves the absolute right, in its sole judgment and discretion, to substitute appliances, materials, fixtures and equipment of equal or greater quality or value for those specified. Units denoted on key plan as similar units may vary in size and dimensions from the plan featured above.